

# Bobcat™ 265

Gas or LP Engine-Driven Welder 

## Quick Specs

### Industrial Applications

Maintenance  
Repair  
Work trucks  
Farm/ranch  
Fabrication  
Structural steel work

### Processes

Stick (SMAW)  
MIG (GMAW)\*  
Flux-cored (FCAW)\*  
DC TIG (GTAW)  
Air carbon arc (CAC-A)  
cutting and gouging (3/16 in. carbons)  
Air plasma cutting and gouging with optional Spectrum® models

\*With wire feeder.

### Output Range

DC stick/TIG 20–265 A  
MIG/flux-cored 14–30 V

### Auxiliary Power Output Rated at 104°F (40°C)

11,000 watts peak, 9,500 watts continuous

### Battery Charge/Crank Assist (option)

Battery charge 12/24 V, 150 A  
Crank assist 12/24 V, 300 A

Reliable, easy to use and more capable engine-driven welders great for stick and flux-cored welding. Designed for maintenance/repair operations, construction, and auxiliary power use.

The most popular engine-driven welder in the industry, the Bobcat is:

- Quiet to operate
- Small and light
- Easy to maintain



### Easy to use

Digital interface speeds machine setup and makes it less complicated.



### Separate weld and auxiliary power

Full auxiliary power at any setting.

### ArcReach®

Parameter control at the wire feeder or pendant without needing a control cord. See page 2.



**NEW!**

Bobcat 265 with battery charge/crank assist model shown.



### Remote start/stop

Easily turn your Bobcat machine on and off remotely, so it only runs when you need it. See page 2.



### Exceptional arc performance

Easy arc starts and less spatter.



### Easier mobility and uses less truck space and payload

Over 100 pounds lighter and 13 percent smaller than previous model.



### Easy maintenance

With its intuitive design, the daily maintenance of our Bobcat engine-driven welder is fast and easy.



Engine-driven welder is warrantied for three years, parts and labor.  
Engine is warrantied separately by the engine manufacturer.



### Miller Electric Mfg. LLC

An ITW Welding Company  
1635 West Spencer Street  
P.O. Box 1079  
Appleton, WI 54912-1079 USA

### Equipment Sales US and Canada

Phone: 866-931-9730  
FAX: 800-637-2315  
International Phone: 920-735-4554  
International FAX: 920-735-4125

### MillerWelds.com



# The Bobcat™ Advantage

## Remote start/stop

Take control and eliminate engine noise. Easily turn your Bobcat machine on and off remotely so it only runs when you need it. Get more out of each tank, extend time between maintenance and work without the hassle of walking back to your machine.

The remote start/stop on the Bobcat 265 engine-driven welder is installed and backed by Miller — so it's just as easy to use and dependable as your Bobcat machine.

### SIMPLE

One button: press to start the engine-driven welder; press again to turn it off.

### DURABLE

Tough and water-resistant, with a three-year warranty.



### TWO-WAY COMMUNICATION

After start or stop command is received by the engine-driven welder the fob lights up and beeps.

### EASILY ORDER ADDITIONAL FOBS

Order stock number 286385.

## Auto-Set™ technology

Auto-Set offers predefined weld settings to increase ease of use and ensure that the job is done right for operators of all skill levels.



## Data visibility

Predictive maintenance information helps you plan necessary service time. Productivity screens make it easier for you to monitor machine use.

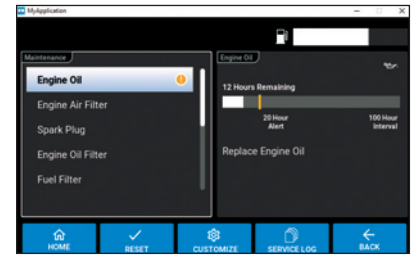

## Direct spool gun connection

Make it easy to weld aluminum. Expand the types of jobs you can take on. Adapters are no longer required with the integrated 10-pin connection. Optimized for Spoolmate™ and Spoolmatic® spool guns.



## Designed for reliability

From Appleton, Wisconsin USA, our engine-driven welders are the most rugged, durable and long-lasting in the industry. We manufacture them to exceed requirements for extreme working conditions and they are hard-working from the core with:

- Copper windings and robust internal components for a quality-built machine
- Lugged — not soldered — heavy internal leads for better field durability
- Superior cooling technology for maximum performance and engine life
- Protective doors to cover the weld studs and receptacles as required by OSHA and CSA for jobsite safety
- Lift hook integrated into the center frame, which bolts to the machine's base for greater durability

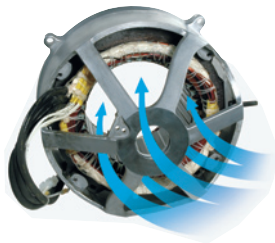

## Small, light design

Bobcat engine-driven welders take up less space on trucks and trailers — leaving more room on your truck for other equipment and tools. Plus, they're easier to move around jobsites — even with weld cables attached.



## Long runtimes

Large 11-gallon fuel capacity means many hours of run time before refueling. Improved fuel system design reduces a no-start condition if overfilled.

## ArcReach® technology (option)

### ArcReach® Parameter control at the wire feeder or pendant without needing a control cord.

An ArcReach system allows you to change weld settings from your ArcReach feeder or stick/TIG remote, saving a trip to the power supply. ArcReach technology uses the existing weld cable to communicate welding control information between the feeder or stick/TIG remote and the power source. This technology eliminates the need for control cords, and their associated problems and costs.

*Note: ArcReach is not available on the Battery Charge/Crank Assist model.*

## Battery charge/crank assist (option)

**Reduce downtime with battery charge/crank assist capability.** Designed and recommended for mechanics or anyone else responsible for a fleet of trucks or equipment. By using your Bobcat to charge dead batteries or jump a stubborn engine, you'll keep your crew working and the fleet up and running.

*Note: Battery charge/jump cables (300422) must be ordered separately.*

# The Bobcat™ Advantage

## Easy maintenance

With its intuitive design, the daily maintenance of our Bobcat engine-driven welders is fast and easy. Front panel maintenance displays help you know when your equipment needs to be serviced. And servicing is simple because of:

- Oil checks that can be performed easily through the top of the machine by the access door
- Toolless panels that allow for quick access
- Single-side fuel fill and oil drain/filter

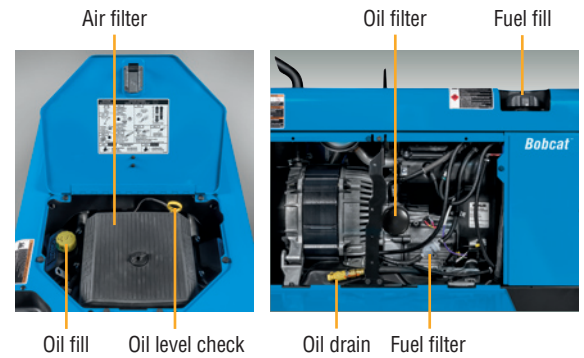

## Reversed air flow for optimized cooling

Exclusive engine and interior componentry design operates cooler and more efficiently. The engine is rotated towards the front to create more efficient airflow. More efficient airflow and exclusive engine location are significant contributors to reduced sound level and size reduction. Hot air recirculation is eliminated when machine is mounted in tight spots, and internal parts are kept cool for optimal performance.

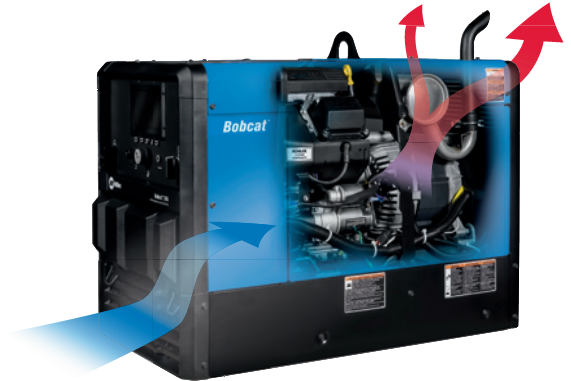

## Accu-Rated™ – not inflated auxiliary power

Our Accu-Rated™ 11,000 watts of *usable* peak power is delivered for a minimum of 30 seconds. Accu-Rated means peak power is usable for maximum auxiliary power loads such as plasma cutting, Millermatic® MIG welders and motor starting. Accu-Rated peak power beats the competition's very short-duration peak or surge power. Use your peak power, it's more than a number.

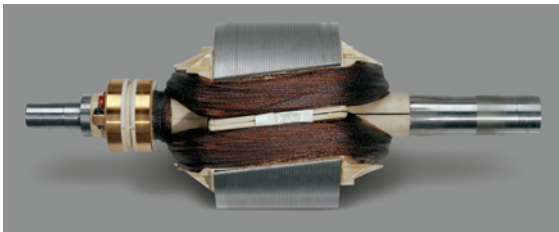

## Smooth power – not spike power

Revolutionary ten-degree skewed-rotor design optimizes auxiliary power performance for smoother power — not spiked power found with other brands. Better power — better performance.

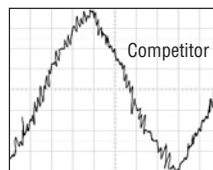
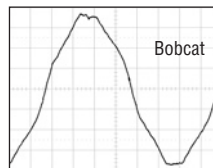

Waveform Comparison

Auxiliary Power Curve

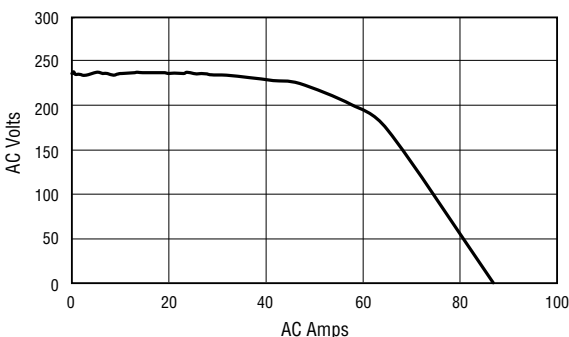

Tools and motors are designed to operate within 10 percent of 120/240 V. The auxiliary power of the Bobcat provides strong power while keeping the voltage within 10 percent of 120/240 V. **This increases tool/motor performance and life.**

## Typical equipment power usage

Bobcat engine-driven welders will easily start and run the following equipment:

Equipment	Starting Watts	Running Watts
Barn Cleaner (5 hp)	11,600	3,000
Silo Unloader (5 hp)	12,200	4,300
Portable Conveyor (1/2 hp)	3,400	1,000
Milker (5 hp)	10,500	2,800
Hand Drill (1/2 inch)	600	600
Circular Saw (8-1/4 inch)	1,400	1,400
Air Compressor (1-1/2 hp)	8,200	2,200
Flood Lights (Vapor)	1,250	1,000
Spectrum® 625 X-TREME™ (30 A, 230 V, 1/2-inch cut)	6,900	6,900

To size a unit that has enough power output in watts, add the watts for the items you want to simultaneously run. Tools with induction motors may require three to seven times the listed wattage when starting. **All data listed is approximate — check your tool for specific wattage requirements.**

# Specifications (Subject to change without notice.)



Welding Mode	Process	Amp/Volt Ranges	Rated Weld Output at 104°F (40°C)*	Single-Phase Auxiliary Power	Sound Levels	Dimensions	Net Weight**
CC/DC	Stick/TIG <sup>1</sup>	20–265 A	265 A at 27 V, 100% duty cycle	Peak: 11,000 watts Continuous: 9,500 watts 120/240 V, 88/44 A, 60 Hz	73.1 dB/72.5 dB	H: 26.5 in. (673 mm) H: 31.2 in. (792 mm) (to top of exhaust) W: 20.13 in. (511 mm) D: 37.06 in. (941 mm)	382 lb. (173 kg)
CV/DC	MIG/FCAW	14–30 V	265 A at 27 V, 100% duty cycle				

Note: Derate outputs up to five percent when using LP fuel. \*Rated at sea level. \*\*Net weight without fuel.

Certified by Canadian Standards Association to both the Canadian and U.S. Standards.

## Engine Specifications (Engines warranted separately by the engine manufacturer.)

Engine Brand and Warranty	Horsepower (HP)	Type	Weld Speed	Idle Speed	Fuel Capacity	Oil Capacity	Standard Shutdowns
Kohler CH730, 3-year warranty	Gas: 23.5 hp at 3,600 rpm LP: 21 hp at 3,600 rpm	Twin-cylinder, four-cycle overhead valve, industrial air-cooled, gasoline* or LP**	3,600 rpm	2,300 rpm	11 gal. (41.6 L)	1.8 qt. (1.7 L)	Low oil pressure

\*Fuel stabilizer is recommended for gas engines that are used infrequently. \*\*Hose and LP Tank Mounting Assembly and setup are required.

## Performance Data

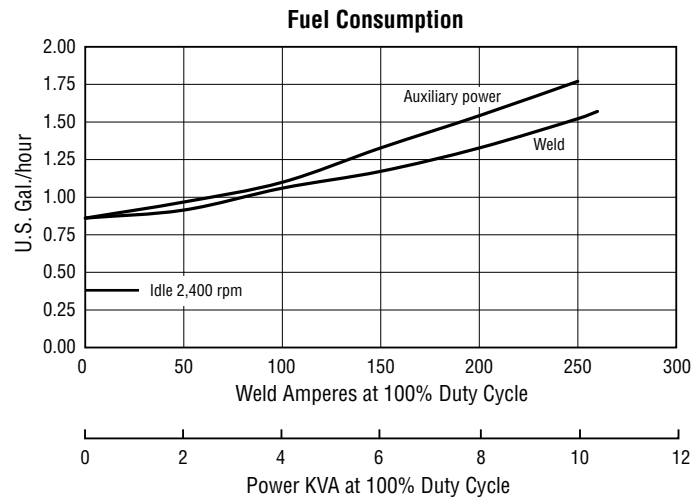

## Mounting Specifications

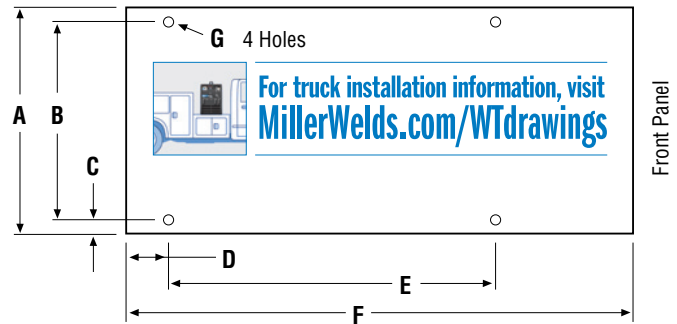

- A. 20 in. (508 mm)
- B. 16.5 in. (419 mm)
- C. 1.75 in. (44.5 mm)
- D. 3.18 in. (81 mm)
- E. 22.3 in. (566 mm)
- F. 37 in. (940 mm)
- G. .406 in. (10.3 mm) diameter

## Fuel Consumption Data

- 11-gallon fuel capacity.
- On a typical job using 1/8-inch 7018 electrodes (125 A, 20% duty cycle) expect about 11.7 hours (gas) of operation.
- Under a continuous load of 4,000 watts of auxiliary power, the Bobcat would run for about 10 hours (gas) of operation.

## Choose the Right Bobcat™ Engine Drive

Fuel System	Bobcat 230	UPGRADE	Bobcat 265
Fuel Type	Gasoline		Gasoline or LP
Delivery	Carburetor (manual choke)	➔	Carburetor (gas: eChoke™ / LP: manual choke)
<b>Weld</b>			
Output	DC only, CC/CV		DC only, CC/CV
Processes	Stick / MIG / FCAW	➔	Stick / TIG / MIG / FCAW / Gouge
Amperage Range	20–230 A	➔	20–265 A
Voltage Range	14–25 V	➔	14–28 V
<b>Auxiliary Power</b>			
Peak Watts	11,000 watts		11,000 watts
Continuous Watts	9,500 watts		9,500 watts
<b>Sound Levels</b>			
Maximum / At Idle	73.1 dB / 64 dB		73.1 dB / 64 dB
<b>Dimensions</b>			
Size (H x W x D)	26.5 x 20.13 x 37.06 in.		26.5 x 20.13 x 37.06 in.
Weight	376 lb.		382 lb.
<b>Key Features</b>			
Display	Knob	➔	LCD
Maintenance	Fuel / hour / oil	➔	Predictive maintenance
Auto-Set™	—	➔	Yes
Battery Charge / Crank Assist	—	➔	150 A charge / 300 A crank (option)
ArcReach®	—	➔	Option
Spool Gun	—	➔	Direct connect
Remote Start/Stop	—	➔	Yes

Note: See MillerWelds.com or the Full-line Catalog to compare to Trailblazer models.

## Function and Benefit Guide

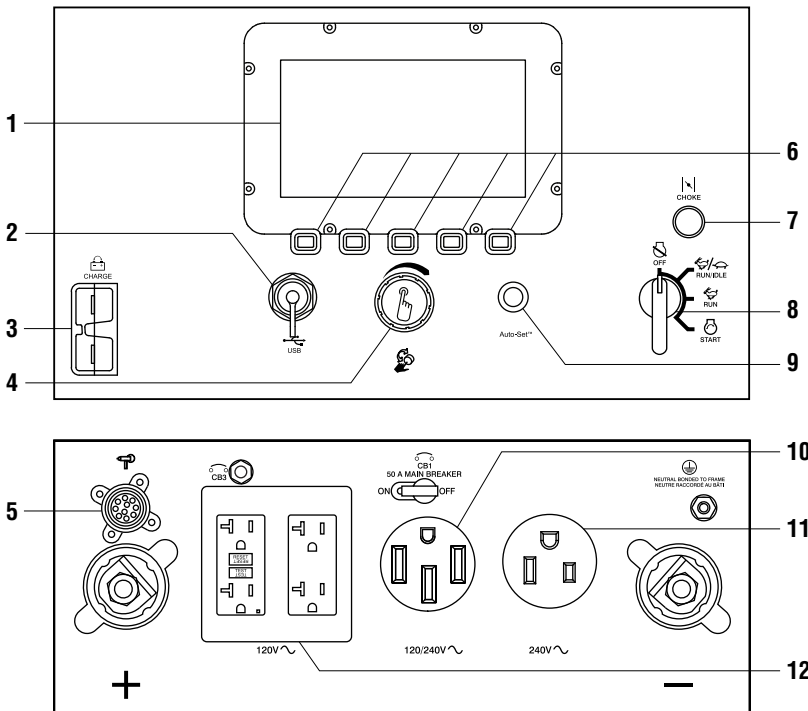

- Digital display** provides weld process and parameters, fuel level, maintenance and machine use information.
- USB port** allows software updates from a USB drive. A summary file of recorded data from the unit will be saved to a USB drive that is inserted.
- Optional battery charge/crank assist receptacle.**
- Pushbutton main control knob** used for adjusting amperage/voltage and accessing the service menu.
- Standard 10-pin receptacle** for simple connection of spool guns. See page 7.
- Pushbuttons** used for selection of weld process, menu and other machine features.
- LP model**— Engine choke control is used for easy engine starting.
- Engine control switch** is used to start the engine and then select between auto idle and high speed lock positions.
- Auto-Set™ button** provides process-specific pre-defined parameters.
- 120/240 V receptacle with circuit breaker.**  
(For matching plug, order 119172.)
- 240 V receptacle with circuit breaker.**
- 120 V GFCI receptacles with circuit breaker.**

## Genuine Miller® Options \*Available as factory option. See ordering information on back page.

### LP Gas\*

Liquid withdrawal LP system with vaporizer and regulator. Does not include tanks, brackets or hose from tank to regulator.

*Note: Requires Hose and LP Tank Mounting Assembly 301710.*

### Electric Fuel Pump\* 301741 Field

Recommended for gas engine operations at altitudes above 5,000 feet. Improves engine starting and high-output performance.

### Spark Arrestor 300924 Field

Mandatory when operating on California grasslands, brush or forest-covered land, and all national forests. For other areas, check your state and local laws.



Female  
Receptacle



### Full KVA Adapter Cord 300517 Field

NEMA 14-50P to NEMA 6-50R. Adapts engine drive 120/240 V plug to common Millermatic® and Spectrum® 240 V plug.



**Full KVA Plug 119172 Field**  
120/240 V, 50 A plug (NEMA 14-50P) to fit full KVA receptacle.

### Engine Tune-Up Kits

**284083 Field.** Kohler CH730 (gas)

**252838 Field.** Kohler CH730 (LP)

Includes air and fuel filters, and two spark plugs.

## Genuine Miller® Accessories



### Never Flat™ Tires

Available on Bobcat and Trailblazer running gear.

- Reduce costly jobsite downtime

- Maintain constant tire pressure and will not develop flats
- Protect against punctures
- Preserve maneuverability, even when weighed down with heavy welding cable



### Multi-Terrain Running Gear with Never Flat Tires 301708

Includes two heavy-duty 15-inch tires, two 8-inch rubber swivel casters and a

heavy-duty handle. Recommended for all surfaces and applications, and is easy to move around the jobsite.



### Hose and LP Tank Mounting Assembly 301710 LP only

Designed for use with multi-terrain running gear, protective cage, or by itself. Includes bracket and clamp to mount 33- and 43-pound tanks horizontally, and hose with fittings to converter.

*Note: Not for use with gas cylinder mounting assembly. Not recommended for use with protective cover.*



### Off-Road Running Gear with Never Flat Tires 301706

Includes four heavy-duty 15-inch tires and a rugged handle to provide maximum maneuverability.



### Protective Cage with Cable Holders 301709

Rugged cage with cable holders protects your investment. Can be used with running

gear, gas cylinder mounting assembly, or trailer.



### 25-foot Battery Charge/Jump Cables with Plug 300422



### Off-Road Running Gear with Protective Cage and Never Flat Tires 301707

Running gear allows easy movement around jobsite and rugged cage with

cable holders protects your investment.



### Gas Cylinder Mounting Assembly 301711 Gas only

Designed for use with multi-terrain running gear, protective cage, or by itself.

Includes base tray with bottle bracket, vertical support rack and safety chain.

*Note: Not for use with LP tank mounting assembly. Not recommended for use with protective cover.*



### Protective Covers 301712

For use **without** protective cage or running gear (shown)

### 301713

For use **with** protective cage and/or running gear

Heavy-duty, water- and mildew-resistant covers protect and maintain the finish of the welder.



### Remote Start/Stop Fob 286385

For use with Bobcat 265 engine-driven welders equipped with remote start/stop. Fob can be easily paired with compatible machines.

# Genuine Miller® Accessories (Continued)

## MIG/Flux-cored Welding



**Millermatic® 141 907612**

See literature DC/12.42

**Millermatic® 211 907614**

See literature DC/12.58

The Millermatic line of MIG welders are complete arc welding power source, wire feeder and gun packages designed for portability and ease of use.

*Note: The Millermatic machines can be operated utilizing auxiliary power.*



**ArcReach® SuitCase® 8**

**951726001** With Bernard® BTB Gun 300 A

**951727** With Bernard® S-Gun™

**951728** With Bernard® Dura-Flux™ gun

**ArcReach® SuitCase® 12**

**951729001** With Bernard® BTB Gun 300 A

**951730** With Bernard® S-Gun™

**951731** With Bernard® Dura-Flux™ gun

Portable feeder designed to run off of arc voltage. See literature M/6.55.



**Spoolmatic®  
30A Spool Gun  
130831**

Rated at 200 amps, 100 percent duty cycle with

30-foot (9 m) cable. See literature M/1.73.



**Spoolmate™  
200 Spool Gun  
300497**

Rated at 160 amps, 60 percent duty cycle with

20-foot (6 m) cable. See literature M/1.47.

## Stick (SMAW) Welding

**Weld Leads**

**2/0 Stick Cable Set, 50 ft. (15 m) 173851**

Consists of 50-foot (15 m) 2/0 electrode cable with holder, and 50-foot (15 m) work cable with clamp. 350 A, 100% duty cycle.

**2/0 Stick Cable Set, 100/50 ft. (30.5/15 m) 043952**

Consists of 100-foot (30.5 m) 2/0 electrode cable with holder, and 50-foot (15 m) work cable with clamp. 300 A, 100% duty cycle.

## TIG (GTAW) Welding



**Dynasty® 210 Series**

For portable AC/DC TIG. See literature AD/4.81.

## Multiprocess Welding



**Multimatic® 215 907693**

Portable, all-in-one multiprocess package weighs only 38 pounds (17.2 kg), and features excellent arc characteristics. Exclusive multi-voltage plug (MVP™) provides flexibility to plug into 120- or 240-volt power. Take it anywhere you need to MIG, TIG or stick weld. See literature DC/12.59.

## Remote Solutions



**ArcReach® Stick/TIG Remote 301325**

When paired with an ArcReach power source, provides remote control of the power source without a control cord — saving time

and money. See literature AY/14.5.

## Plasma Cutting



*Spectrum 375 X-TREME and 625 X-TREME shown.*

**Spectrum® 375 X-TREME™ 907529**

See literature PC/9.2.

**Spectrum® 625 X-TREME™ 907579**

See literature PC/9.6.

**Spectrum® 875 907583**

See literature PC/9.8.

The Spectrum 375 X-TREME and 625 X-TREME come complete with protective X-CASE™ (not shown).

## Trailers and Hitches



**HWY-Mid Frame Trailer 301438**

1,424-pound (646 kg) capacity highway trailer with welded steel tubing frame, heavy-duty axle with roller bearing hubs and leaf-spring suspension. Includes jack stand, fenders, lights, and dual hitch with 2-inch (50 mm) ball hitch and 3-inch (76 mm) lunette eye.

*Note: Trailer is shipped unassembled.*



**Cable Tree 043826**

Provides an area to conveniently wrap weld cables and extension cords.



**2-In-1 Document/  
Fire Extinguisher Holder  
301236**

Stores documents and holds a five-pound fire extinguisher.

*Note: Holder shown mounted on trailer. Fire extinguisher not included.*

# Ordering Information

Equipment and Options	Stock No.	Description	Qty.	Price
<b>Bobcat™ 265</b>	<b>907826</b>	Kohler engine with GFCI receptacles and remote start/stop		
	<b>907826001</b>	Kohler engine with GFCI receptacles, remote start/stop and ArcReach™		
	<b>907826002</b>	Kohler engine with GFCI receptacles, remote start/stop and battery charge/crank assist		
	<b>907826003</b>	Kohler engine with GFCI receptacles, electric fuel pump and remote start/stop		
<b>Bobcat™ 265 LP</b>	<b>907827</b>	Kohler engine with GFCI receptacles		
<b>Field Options</b> <i>Options listed below can be added to the above packages. Installation is required.</i>				
Electric Fuel Pump	<b>301741</b>	Recommended for gas engine operations at altitudes above 5,000 feet		
Spark Arrestor	<b>300924</b>			
Full KVA Adapter Cord	<b>300517</b>			
Full KVA Plug	<b>119172</b>			
Engine Tune-Up Kits	<b>284083</b> <b>252838</b>	For Kohler CH730. Includes air and fuel filters, and two spark plugs For Kohler CH730 (LP). Includes air and fuel filters, and two spark plugs		
<b>Accessories</b>				
Off-Road Running Gear	<b>301706</b>	With Never Flat™ tires		
Off-Road Running Gear with Protective Cage	<b>301707</b>	With Never Flat™ tires		
Multi-Terrain Running Gear	<b>301708</b>	With Never Flat™ tires		
Protective Cage with Cable Holders	<b>301709</b>			
Gas Cylinder Mounting Assembly	<b>301711</b>	Gas models only. <i>Not for use with LP tank mounting assembly. Not recommended for use with protective cover</i>		
Hose and LP Tank Mounting Assembly	<b>301710</b>	LP model only. <i>Not for use with gas cylinder mounting assembly. Not recommended for use with protective cover</i>		
25-foot Battery Charge/Jump Cables w/Plug	<b>300422</b>			
Protective Covers	<b>301712</b>	For use <b>without</b> protective cage or running gear		
	<b>301713</b>	For use <b>with</b> protective cage and/or running gear		
Remote Start/Stop Fob	<b>286385</b>			
<b>MIG/Flux-cored Welding</b>				
Millermatic® Series MIG Welders		See page 7		
ArcReach® SuitCase® Wire Feeders		See page 7		
Spoolmatic® 30A Spool Gun	<b>130831</b>	See literature M/1.73		
Spoolmate™ 200 Spool Gun	<b>300497</b>	See literature M/1.47		
<b>Stick Welding</b>				
		See page 7		
<b>TIG Welding</b>				
		See page 7		
<b>Multiprocess Welding</b>				
		See page 7		
<b>Remote Solutions</b>				
		See page 7		
<b>Plasma Cutting</b>				
		See page 7		
<b>Trailers and Hitches</b>				
HWY-Mid Frame Trailer	<b>301438</b>	Trailer with lights, fenders and dual hitch. For highway use		
Cable Tree	<b>043826</b>	Trailer-mounted cable holder		
2-In-1 Document/Fire Extinguisher Holder	<b>301236</b>	Stores documents and holds a five-pound fire extinguisher		

Date:

Total Quoted Price:

Distributed by:

